

The logo for FLW (Fore Lumber Works) is located in the top left corner of the page. It consists of the letters 'FLW' in a stylized, italicized font with a horizontal line through them, set against a black background.

ZIPPA LITE ES (E7000/E8000) Chain Guide Installation

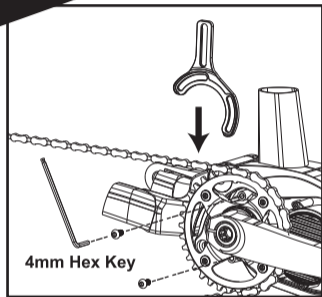

Step 1:

Install the mounting plate (without the top guide) directly onto the tabs.

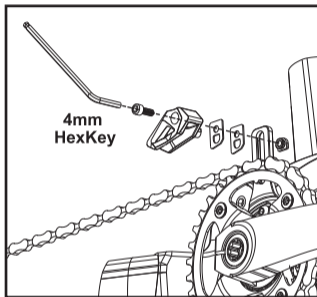

Step 2:

Install the top guide onto the top of the mounting plate. Check for alignment between the chain and the top guide. If alignment looks good, skip to step 4.

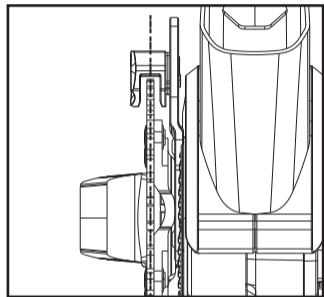

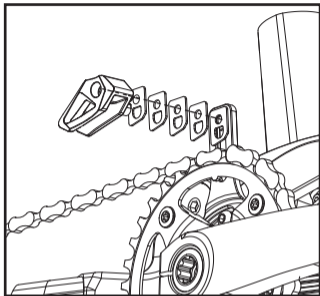

Step 3:

Use the spacers to adjust alignment between the guide and the chain. If you use more than one spacer, use the longer screw to bolt the top guide.

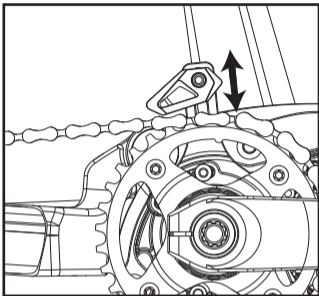

Step 4:

Adjust the height of the top guide so that it is as low as possible without touching the chain, chain ring, and chain ring bolts.

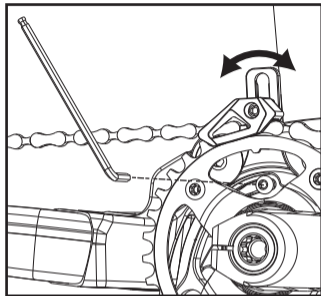

Step 5:

To adjust the angle of chain guide, loosen the bolts in tabs. Adjust the guide to cover the chain as much as possible without touching the chain. Run through the gears and make sure the chain does not rub against the guide. When the angle is right, tighten the bolts.